

SUPER BLUE FLEX HOSE

Applications

The blue line is known worldwide as a mark of Irritrol System quality in irrigation. This same quality can be found in Super Blue Flex Hose. Ideal for installing sprayheads (especially in difficult conditions) because it is extremely flexible, easy to handle and to use.

Features

- Very low density polyethylene
- Maximum working pressure, 5,5 bar at 35°C
- Reel length: 30 metres
- Inside tube diameter 12,5 mm.
- Minimum wall thickness 2,4 mm.
- Shrink-wrapped coils
- Compatible with all fittings ranges of: Olson E-Z-Ell, Dura, Toro, Rain Bird and many others.
- The reels are wound to allow unwinding from center of coil.

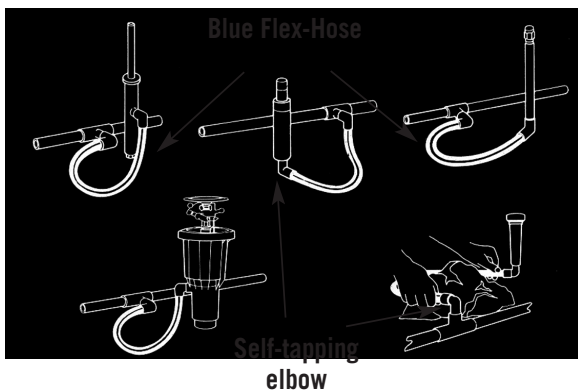

Code

EHD1295-010

Blue Flex-Hose

SELF-THREADING ELBOW



Features

- 1/2" or 3/4" male thread
- Automatic threading of the hose onto the elbow union without, teflon etc.
- 90° design for easy installation
- Maximum working pressure 7 bar
- Use it with Super Blue Flex Hose.

Code

IT-FEM1515

1/2" male Self-threading Elbow

IT-FEM2015

3/4" male Self-threading Elbow

SWING JOINT

Features

- Ready-made assembly that simplifies and speeds up installation of irrigation systems
- Essential for perfect ground levelling of sprinklers
- Suitable for large projects
- Body in Hi-Impact PVC
- 360° rotation in three directions
- Max. working pressure, 13,6 bar at 22°C
- Seal guaranteed by O-ring gasket.

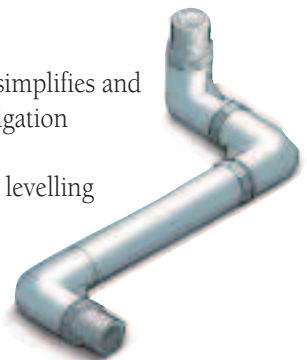

Code

IT-TPK025

1" Swivel riser

IT-TPK040

1 1/2" Swivel riser